

BUILDING-STRUCTURE INVENTORY FORM

DIVISION FOR HISTORIC PRESERVATION
NEW YORK STATE PARKS AND RECREATION
ALBANY, NEW YORK (518) 474-0479

FOR OFFICE USE ONLY
UNIQUE SITE NO. 029-40-0184-009
QUAD _____
SERIES _____
NEG. NO. _____

YOUR NAME: Jonathan F. Hoepfinger DATE: July 11, 1978

YOUR ADDRESS: 273 Georgia St. Buffalo TELEPHONE: (716) 856-0899

ORGANIZATION (if any): West Village Community Association

NOV 17 1978

IDENTIFICATION

- 1. BUILDING NAME: S.H. Pooley Belting Inc.
- 2. COUNTY: Erie TOWN/CITY: Buffalo VILLAGE: _____
- 3. STREET LOCATION: 207 Huron St.
- 4. OWNERSHIP: a. public b. private
- 5. PRESENT OWNER: James S. Howell ADDRESS: Same
- 6. USE: Original: Belting manufacturing Present: Belting manufacturing
- 7. ACCESSIBILITY TO PUBLIC: Exterior visible from public road: Yes No
Interior accessible: Explain By permission

DESCRIPTION

- 8. BUILDING MATERIAL: a. clapboard b. stone c. brick d. board and batten
e. cobblestone f. shingles g. stucco other: Conc. block
- 9. STRUCTURAL SYSTEM: a. wood frame with interlocking joints
(if known) b. wood frame with light members
c. masonry load bearing walls
d. metal (explain) _____
e. other _____
- 10. CONDITION: a. excellent b. good c. fair d. deteriorated
- 11. INTEGRITY: a. original site b. moved if so, when? _____
c. list major alterations and dates (if known): Concrete block addition built.

12. PHOTO:

13. MAP:

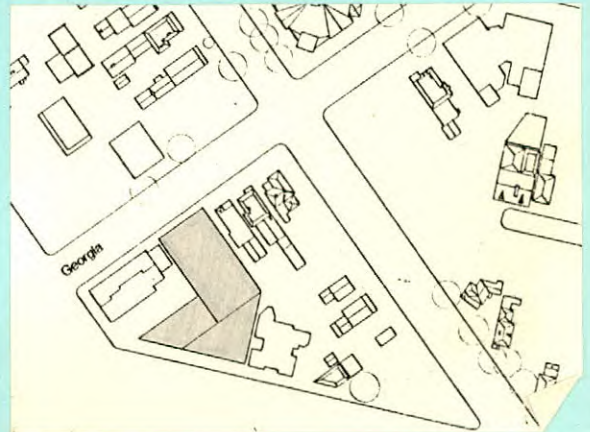

14. THREATS TO BUILDING: a. none known b. zoning c. roads
 d. developers e. deterioration
 f. other: _____
15. RELATED OUTBUILDINGS AND PROPERTY:
 a. barn b. carriage house c. garage
 d. privy e. shed f. greenhouse
 g. shop h. gardens
 i. landscape features: This is an urban, light-industrial
complex
 j. other: _____
16. SURROUNDINGS OF THE BUILDING (check more than one if necessary):
 a. open land b. woodland
 c. scattered buildings
 d. densely built-up e. commercial
 f. industrial g. residential
 h. other: Shoreline Complex

17. INTERRELATIONSHIP OF BUILDING AND SURROUNDINGS:
 (Indicate if building or structure is in an historic district)

S.H. Pooley Belting situates itself towards the corner created by Huron and Georgia Streets forming a point at Niagara Street. This industrial grouping of structures is located among commercial and residential uses. Across Niagara Street is the Shoreline Complex.

18. OTHER NOTABLE FEATURES OF BUILDING AND SITE (including interior features if known):

S.H. Pooley Belting is a group of structures that have angular massing and flat facades that draw one's attention towards the loading dock.

SIGNIFICANCE

19. DATE OF INITIAL CONSTRUCTION: c. 1940

ARCHITECT: _____

BUILDER: _____

20. HISTORICAL AND ARCHITECTURAL IMPORTANCE:

S.H. Pooley Belting stands on lots #48, #49, and #53 of the original Stephen Whitney Estate. These lots were passed on to William Whitney according to the Stephen Whitney Will, 1862. These lots sat vacant through the periods of Victorian building and the apartment renaissance until this industry brought in a completely different land use to the West Village. It is interesting that a full production industry can be located within the limits of an architecturally Victorian neighborhood.

21. SOURCES:
 "Map of Stephen Whitney's holdings in Buffalo, N.Y.," June 17, 1861.

22. THEME:
 Residential Patterns of a Unique Victorian Neighborhood